

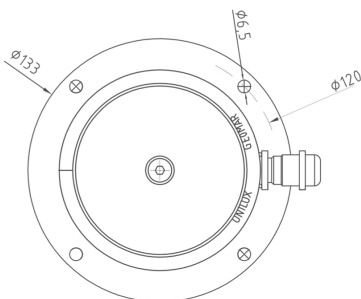

S50 Led | LED Navigation Light

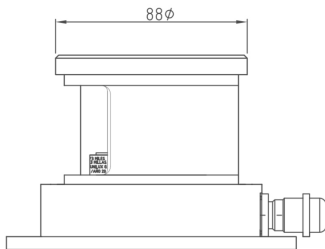

Starboard	Port	Masthead	Stern	Towing	Signalling	Manoeuvring	Suez	Steering
112,5° 3nm	112,5° 3nm	225° 6nm	135° 3nm	135° 3nm	360° 3nm	360° 3nm	135° 3nm	30° >2nm

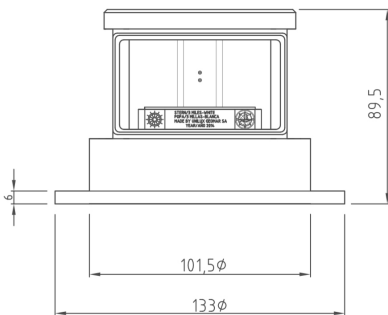

Application and Requirements

For all sea going vessels with a length of 20 meters or more

According to:

- International Regulations for Preventing Collisions at Sea 1972 (72 COLREGS – IMO72)
- EN-ISO 14744
- EN 60945 (2002)

Approval

DNV-GL | MED Certificate.

Technical Features

Housing:	Hard anodized seawater resistant aluminum
Lens:	Borosilicate glass
Fully resistant to sea environment	
Non magnetic	
Operational temperature:	From -25° C to +55° C
Protection:	IP68
Lifetime:	Approx. 50.000 hours for main plus 50.000 hours for spare light (main and spare light combined in the same module)
Weight:	1 Kg
Power supply:	24 V
Power consumption:	3-15W
Mounting and cable connection:	1,5 mt. electric hose

Optionals

Delivery of custom made lights upon request

DNV-GL | MED Certificate.